



## 2.1 Multimedia Speaker System

### User Manual

Telex and Electro-Voice have been making speakers for some of the biggest names in the music business for over 75 years. Every year of that experience has been engineered into your new EV Sonic XJR multimedia speakers. All you'll have to do is listen and you'll be able to tell that we've taken computer audio to the extreme with hardcore multimedia.



# Setup and Configuration

---

## 1. Connections:

**Note:** Be sure that the power switch is in the off position before connecting and configuring system.

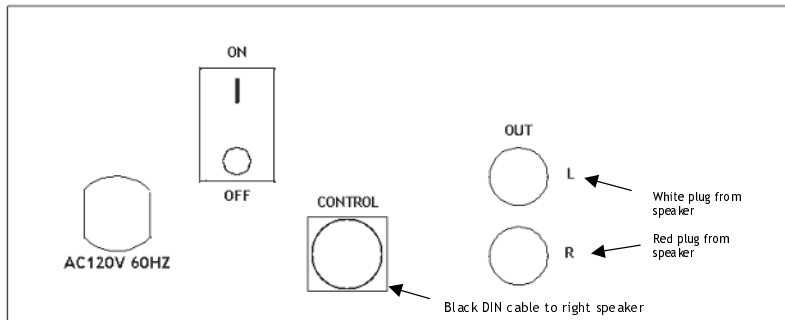

- Connect the right speaker (red plug) to the subwoofer (red jack).
- Connect the left speaker (white plug) to the subwoofer (white jack).
- Connect the subwoofer control cable (Black DIN) to the right speaker.
- Connect the AC power cord on the subwoofer to a wall outlet.

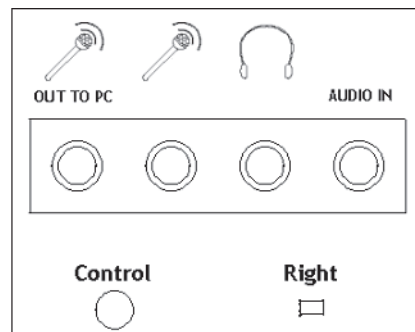

- Connect the right speaker to the PC, using the supplied connector cable
  - Green plug to soundcard (green speaker jack)
  - Green plug to Audio In jack on right speaker
- The following are optional:
  - Connect headphones to the orange headphone jack on the right speaker.
  - Connect a microphone to the pink microphone jack on the right speaker
  - Connect the supplied microphone cable (pink plugs) to the microphone out to PC (pink) jack on the right speaker. Connect the other end of the supplied microphone cable to your sound card's microphone input jack.

# Setup and Configuration (cont')

---

## 2. User controls:

- a. **System power on/off.** Move the power switch on the subwoofer to the desired position. The On position is at the top of the switch. The Off position is at the bottom of the switch. The blue power indicator light will shut off when the speakers are turned off.

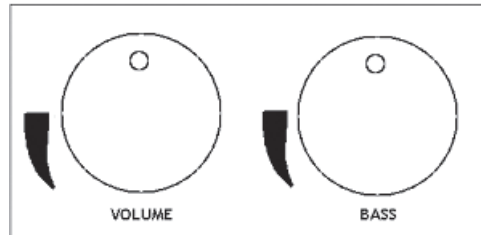

- b. **System volume control.** Turn the control knob clockwise to increase the volume. Turn the knob counterclockwise to reduce the volume.
- c. **Subwoofer volume control.** Turn the control clockwise to increase the subwoofer volume. Turn the control counterclockwise to reduce the subwoofer volume.

- d. **Software volume control.**

**Windows 95.**

1. Go to Start, Programs, Accessories, Multimedia, Volume Control.
2. Adjust the volume slider to the appropriate level. Be sure that Mute is unchecked.

**Windows 98.**

1. Go to Start, Programs, Accessories, Entertainment, Volume Control.
2. Adjust the volume slider to the appropriate level. Be sure that Mute is unchecked.

**Windows Me & 2000.**

1. Go to Start, Programs, Accessories, Entertainment, Volume Control.
2. Adjust the volume slider to the appropriate level. Be sure that Mute is unchecked.

**Windows XP.**

1. Go to Start, All Programs, Accessories, Entertainment, Volume Control.
2. Adjust the volume slider to the appropriate level. Be sure that Mute is unchecked.

## 3. Speaker placement

- a. **Speaker placement.** The satellite speakers are magnetically shielded to prevent interference with your computer's monitor. They can be placed anywhere on your desktop for optimal performance.
- b. **Subwoofer placement.** For best bass response, the subwoofer should be placed on the floor, preferably in a corner or near a solid wall.

# Troubleshooting

---

If there is no sound or very poor quality sound coming from your speakers, follow the steps below:

1. Check that all connections are firmly seated. Check that all icons and plug/jack colors match. Refer to step 1 above in the Setup and Configuration section.
2. Check to be sure that the subwoofer power control is switched to the on position. Refer to step 2a above in the Setup and Configuration section.
3. Check volume levels on both the system and bass controls. Refer to step 2b and 2c above in the Setup and Configuration section.
4. Check the volume controls of your sound card. Refer to step 2d. above in the Setup and Configuration section.

## **Important Playback Level Warning.**

Your EV Sonic XJR speakers are intended for individual or small group listening and can achieve surprisingly high output levels. However, playing bass-heavy program material continuously at overly loud, distorted levels may permanently damage the system's internal fuse. This may result in a non-warranty replacement charge. To avoid this inconvenience, reduce the playback volume when the system shows obvious signs of stress, for example, when it sounds raspy, fuzzy and/or muddy.

# Safety

---

For the safety of you and your equipment, always follow these precautions:

- Keep your speakers away from heat sources, such as radiators, heat registers and other similar appliances.
- Keep your speakers away from liquids.
- Protect your speakers from dampness.
- Keep your speakers from any surfaces or locations that may interfere with their proper ventilation. This includes beds, sofas, rugs or similar surface that may block the ventilation openings. It also includes closed bookshelves or cabinets that may impede the flow of air through the ventilation openings.
- Be sure that your speakers are connected to a power supply only of the type described in the operating instructions or as marked on the appliance.
- Be sure that the grounding or polarization means of the speakers are not defeated.
- Clean your speakers only with a polishing cloth or a soft dry cloth. Never clean with furniture wax, benzene, insecticides or other volatile liquids since they may corrode the cabinet.
- Keep the power cord of your speakers unplugged from the outlet when left unused for a long period of time.

# Service

---

Do not attempt to service your speakers. Call Telex Computer Audio Technical Support (800) 328-3771 for assistance or return the speakers to your dealer.

## FCC Warnings

---

This device complies with Part 15 of the FCC Rules. Operation is subject to the following two conditions:

1. This device may not cause harmful interference, and
2. This device must accept any interference received, including interference that may cause undesired operation.

### Note:

This equipment has been tested and found to comply with the limits of a Class B digital device, pursuant to part 15 of the FCC Rules. These limits are designed to provide reasonable protection against harmful interference in a residential installation. This equipment generates, uses and can radiate radio frequency energy and, if not installed and used in accordance with the instructions, may cause harmful interference to radio communications. There is no guarantee, however, that interference will not occur in a particular installation. If this equipment does cause harmful interference to radio or television reception, which can be determined by turning the equipment off and on, the user is encouraged to try to correct the interference by one or more of the following measures:

- Reorient or relocate the receiving antenna
- Increase the separation between the equipment and receiver
- Connect the equipment into an outlet on a circuit different from that to which the receiver is connected
- Consult the dealer or an experienced radio/TV technician for help

The user is cautioned that changes or modifications not expressly approved by the party responsible for compliance could void the user's authority to operate the equipment.

## Technical Support and Customer Service

---

Phone: (800) 328-3771

e-mail: [computeraudio@telex.com](mailto:computeraudio@telex.com)

Web: [www.computeraudio.telex.com](http://www.computeraudio.telex.com)

# Notes

---

# Notes

---



12000 Portland Ave. S., Burnsville, MN 55337  
952/884-4051 • 952/884-0043 Fax  
©Telex Communications, Inc., 2002